



46" LCD Display
LDT461V



Unveiling high-resolution 46" large display, in full HD 1080P.

1 High quality screen for various business applications

The native resolution of 1920X1080(Full HD), High contrast ratio of 1500:1 and 500cd/m² high brightness ensures clear and crisp picture quality in business environments.



portrait viewing



multi screen

2 Scheduling Function ideal for signage display

The Scheduling Function will provide you the flexibility of managing when your display is ON or OFF, which input signals are displayed at your programmed time. The scheduling function allows for up to 7 unique programmable settings.

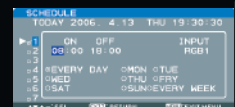

3 Screen Saver useful for long term operation

To increase the life of the LCD panel, the LDT461V includes Screen Saver Function. Special setting such as gamma selection, always active cooling-fan operation, brightness level control, and Orbiting Image function to reduce the possibility of image persistence or sticking.



Connectivity

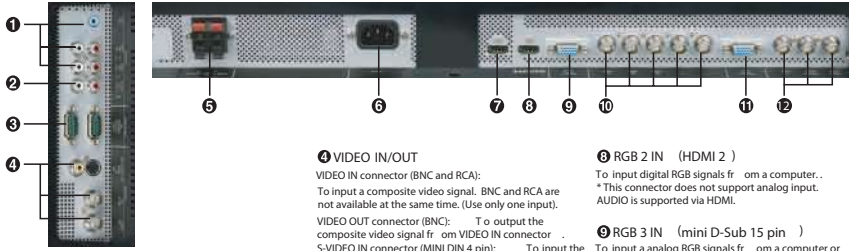

- 1 AUDIO IN 1, 2, 3**
To input audio signal from external equipment such as a computer, VCR or DVD player.
- 2 AUDIO OUT**
To output the audio signal from the AUDIO IN 1, 2 and 3 jack.
- 3 EXTERNAL CONTROL (mini D-Sub 9 pin)**
Connect the IN connector with the RS-232C OUT connector of the computer or a multi-connected LDT461V monitor. Connect the OUT connector with the RS-232C IN connector of LDT461V monitor.

- 4 VIDEO IN/OUT**
VIDEO IN connector (BNC and RCA):
To input a composite video signal. BNC and RCA are not available at the same time. (Use only one input).
VIDEO OUT connector (BNC):
To output the composite video signal from VIDEO IN connector.
S-VIDEO IN connector (MINI DIN 4 pin):
To input the S-video (Y/C separate signal).
- 5 EXTERNAL SPEAKER TERMINAL**
To output the audio signal from external speakers from AUDIO 1, 2, 3 jack or HDMI.
- 6 AC IN connector**
Connects with the supplied power cord.
- 7 RGB 1 IN (HDMI 1)**
To input digital RGB signals from a computer.
* This connector does not support analog input. AUDIO is supported via HDMI.
- 8 RGB 2 IN (HDMI 2)**
To input digital RGB signals from a computer.
* This connector does not support analog input. AUDIO is supported via HDMI.
- 9 RGB 3 IN (mini D-Sub 15 pin)**
To input an analog RGB signals from a computer or other RGB equipment.
- 10 RGB 4 IN (R, G, B, H, V) (BNC)**
To input the analog RGB signals from a computer or other RGB equipment.
- 11 RGB OUT (mini D-Sub 15 pin)**
To output the signal from RGB 3 IN or 4 IN.
- 12 DVD/HD IN (Y, Pb/Cb, Pr/Cr) (BNC)**
Connecting equipment such as a DVD player, HDTV device, or Laser disc player.

Optional Speakers

Weight:
3.1 lbs (1.4 kg) × 2
Audio Output:
7W + 7W (8Ω)

SP-461V

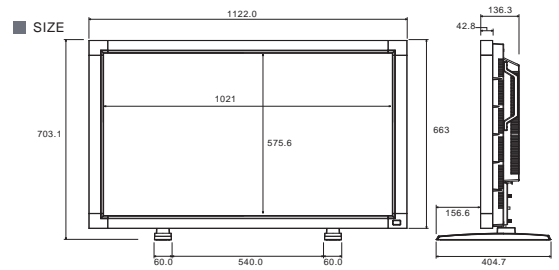

Specifications

		LDT461V	
Item		Analog input	Digital input
LCD Module	Pixel pitch	TFT active matrix, 46" (1168mm) diagonal	
	Resolution	0.530mm (H) x 0.530mm (V)	
	Color	1920 x 1080 dots (FHD)	
	Brightness (typ.)	16.7 Million	
	Contrast ratio (typ.)	500cd/m ²	
	Viewing angle (typ.)	1500:1	
	Response time (typ.)	Up 88deg. / Down 88deg. / Left 88deg. / Right 88deg. (@ CR ≥10)	
Frequency	Horizontal	GTG: 6ms	
	Vertical	15.625 / 15.734, 31.5 - 91.1kHz (Analog/Digital)	
Pixel clock	13.5 - 165.0MHz		25.0 - 165.0MHz
Viewable size		1018.1mm x 572.7mm / 40.1" x 22.5"	
Power management		Yes / VESA DPM	
Plug and play		Yes / VESA DDC2B, DDC/CI	
Auto adjustment		Yes (Contrast / Position / Phase/ Clock)	
OSD user function		Brightness, Contrast, Black level, Zoom, PIP, Screen saver, Side border color, Gamma selection, Black level expansion, Heat status, Power on delay, schedule, Tiling, etc.	
Speaker/Audio output		External Speaker Jack, 7W+7W 8ohm	
Input/Output signal	PC input/output		
	Analog video input/output level	Analog RGB: 0.7Vp-p Input Impedance 75ohm	TMDS (with HDCP)
	Sync. input/output level	Separate: TTL level (Pos. / Neg.) 2.2kohm terminated / Composite sync(0.3Vp-p) / Sync on Green	-
	Input connectors	BNC(R, G, B, H, V) / Mini D-sub 15Pin	HDMI x 2 (with digital audio support)
	Output connector	Mini D-sub 15Pin	-
	Supported resolution	640x480 / 800x600 / 1024x768 / 1360x768 / 1280x1024 / 1600x1200@60Hz / 1920x1080@60Hz / 1920x1200@60Hz	
	Video input/output		
	Video input	Composite 1.0Vp-p Input Impedance 75ohm BNC and RCA pin-jack Input Y/C Y: 1.0Vp-p C: 0.3Vp-p Input Impedance 75ohm S-Terminal-Input	
	Video output	Component 1.0/0.7Vp-p Input Impedance 75ohm BNC-input Composite 1.0Vp-p Input Impedance 75ohm BNC-Output x 1	
	Supported resolution	Composite, Y/C: NTSC, PAL, SECAM, 4.43NTSC, PAL60 Component: 480i, 480p, 720p, 1080i, 1080p	
Audio input	RCA pin-jack L/R Input x 2, Stereo mini Jack Input x 1		
Audio line output	RCA pin-jack L/R output x 1		
Control input/output	Mini D-sub 9pinx1 (Input) / Mini D-sub 9pinx1 (Output) (RS-232C)		
Power supply	3.0-1.3A@100 - 240V AC, 50/60Hz		
Power consumption	Max 285W Power save: Less than 5W (Mechanical power SW Off: 0W)		
Operational environment	Temperature	5 to 40 °C / 41 to 104 °F (Landscape Mode), 5 to 35 °C / 41 to 95 °F (Portrait Mode) *For longer life usage of LCD monitor, operational 25 °C / 77 °F at ambient temperature is recommended.	
	Humidity	20 - 80% (without condensation)	
Storage environment	Temperature	-20 to 60 [°C] / -4 to 140 [°F]	
	Humidity	10 - 90% (without condensation), 90-3.5 x (Temp -40 °C) % regarding over 40 °C / 90-1.95 x (Temp -104 °F) % regarding over 104 °F	
Dimension	Net with stand	1122mm (W) x 703.1 mm (H) x 404.7 mm (D) / 44.17 "(W) x 27.68 "(H) x 15.93 "(D)	
	Net without stand	1122mm (W) x 663mm (H) x 136.3mm (D) / 44.17 "(W) x 26.1 "(H) x 5.37 "(D)	
	Gross	1285mm (W) x 885mm (H) x 275mm (D) / 50.59 "(W) x 37.84 "(H) x 10.83 "(D)	
Weight	Net	Approximately 34.6kg / 76.1lbs (with stand) Approximately 33.0kg / 72.6lbs (without stand)	
	Gross	43 kg / 94.6 lbs	
Wall mounting interface	12 Holes (100mm / 3.94" pitches)		
Complied regulatory and guidelines	UL-60950-1 / C-UL / CE Marking / TUV-GS / BSMI / PSB / GOST-R / FCC-A / DOC-A / C-Tick / RoHS / US Mercury / CCC only for Chinese model		
Warranties	3-years parts and labor, toll free 24x7 technical support, available onsite warranty, repairs and services*		
Accessories	Power Cord , VGA (Mini-Dsub15p) Cable, User's Manual, Wireless Remote Controller, Battery x2, Clamper x2, Screw for Clamper x2, Screw for Main Switch Cover x2, Main switch cover x1, Cable Holder x2, Band x2, Screw for Stand x4, Stand x 1 pair		

* US markets only.

LCD panels are manufactured using high precision technology; nevertheless there may be some missing pixels and some pixels might be always lit on. ● Displaying still pictures for long term may cause permanent image sticking. ● Microsoft Windows™ is a registered trademark of Microsoft Corporation of US in the territory of US and others. ● Macintosh is a registered trademark of APPLE INC. US in the territory of US and others. ● HDMI, HDMI and High-Definition Multimedia Interface™ are trademarks or registered trademarks of HDMI Licensing LLC. ● Other company and product names are a registered trademark or trademark of the relative company.



MITSUBISHI DIGITAL ELECTRONIC PRODUCTS AMERICA, INC.
Presentation Products Division
Toll Free: 888.307.0349
Email: ppinfo@mdea.com
www.mitsubishipresentations.com

CANADA
Mitsubishi Electric Sales Canada, Inc.
Information Technologies Group
Phone: 905.475.7228
www.mitsubishieletrica.ca